

PARISH CENTRE

PRESBYTERY

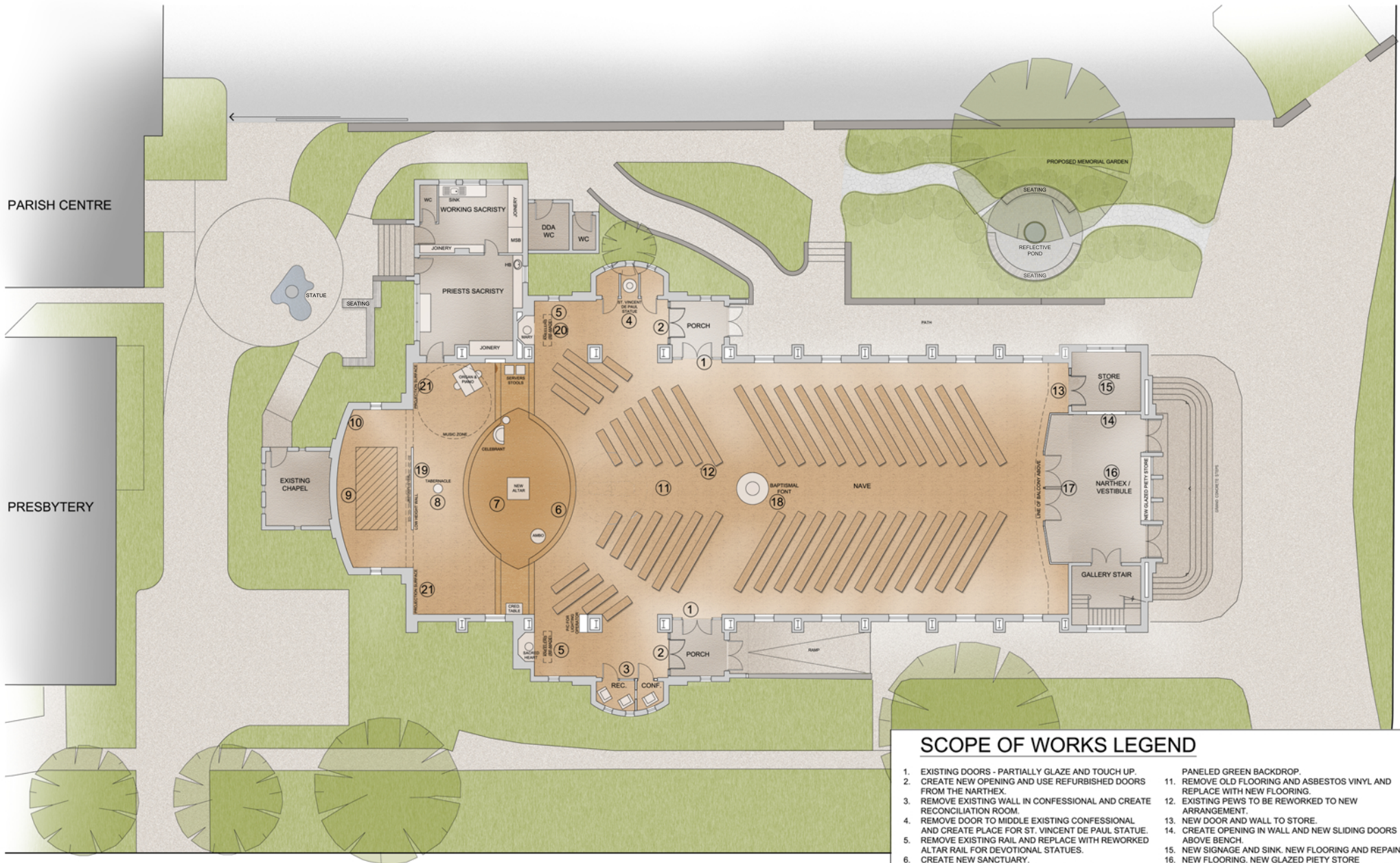

WOODLAND STREET

THE CROSSWAY

PROPOSED CHURCH RESTORATION

ST VINCENT DE PAUL - CHURCH RE-FURBISHMENT
2 THE CROSSWAY, STRATHMORE, 3041

SCOPE OF WORKS LEGEND

- | | |
|--|---|
| 1. EXISTING DOORS - PARTIALLY GLAZE AND TOUCH UP. | 11. REMOVE OLD FLOORING AND ASBESTOS VINYL AND REPLACE WITH NEW FLOORING. |
| 2. CREATE NEW OPENING AND USE REFURBISHED DOORS FROM THE NARTHEX. | 12. EXISTING PEWS TO BE REWORKED TO NEW ARRANGEMENT. |
| 3. REMOVE EXISTING WALL IN CONFESSONAL AND CREATE RECONCILIATION ROOM. | 13. NEW DOOR AND WALL TO STORE. |
| 4. REMOVE DOOR TO MIDDLE EXISTING CONFESSONAL AND CREATE PLACE FOR ST. VINCENT DE PAUL STATUE. | 14. CREATE OPENING IN WALL AND NEW SLIDING DOORS ABOVE BENCH. |
| 5. REMOVE EXISTING RAIL AND REPLACE WITH REWORKED ALTAR RAIL FOR DEVOTIONAL STATUES. | 15. NEW SIGNAGE AND SINK. NEW FLOORING AND REPAIR. |
| 6. CREATE NEW SANCTUARY. | 16. NEW FLOORING. NEW GLAZED PIETY STORE |
| 7. RE PURPOSE EXISTING ALTAR TO SQUARE. | 17. NEW GLAZED WALL CONNECTING NARTHEX TO NAVE. |
| 8. NEW TABERNACLE LOCATION ON NEW PEDESTAL WING. MARBLE FROM HIGH ALTAR. | 18. RELOCATE BAPTISMAL FONT WITH ASSOCIATED DRAINAGE AND STRUCTURAL WORKS. |
| 9. REMOVE HIGH ALTAR AND LEAVE PEDESTAL BASE. RELOCATE EXISTING PIPE ORGAN TO THIS LOCATION. BLACK WOOD SIDES TO ORGAN TO MATCH EXISTING FACE. | 19. SUSPENDED CRUCIFIX OVER SANCTUARY. ALLOW FOR ADJUSTABLE HEIGHT. |
| 10. PAINT EXISTING WALL AND REMOVE OLD ALTAR | 20. REPLACE ELECTRONIC CANDLES WITH REAL CANDLE / TEA LIGHT STAND. |
| | 21. SHORT THROW PROJECTOR WITH PELMET MOUNTED ABOVE. PLASTER WALL AND FINISH TO SUIT. |